

400 EDINBURGH DRIVE

FULLY LEASED

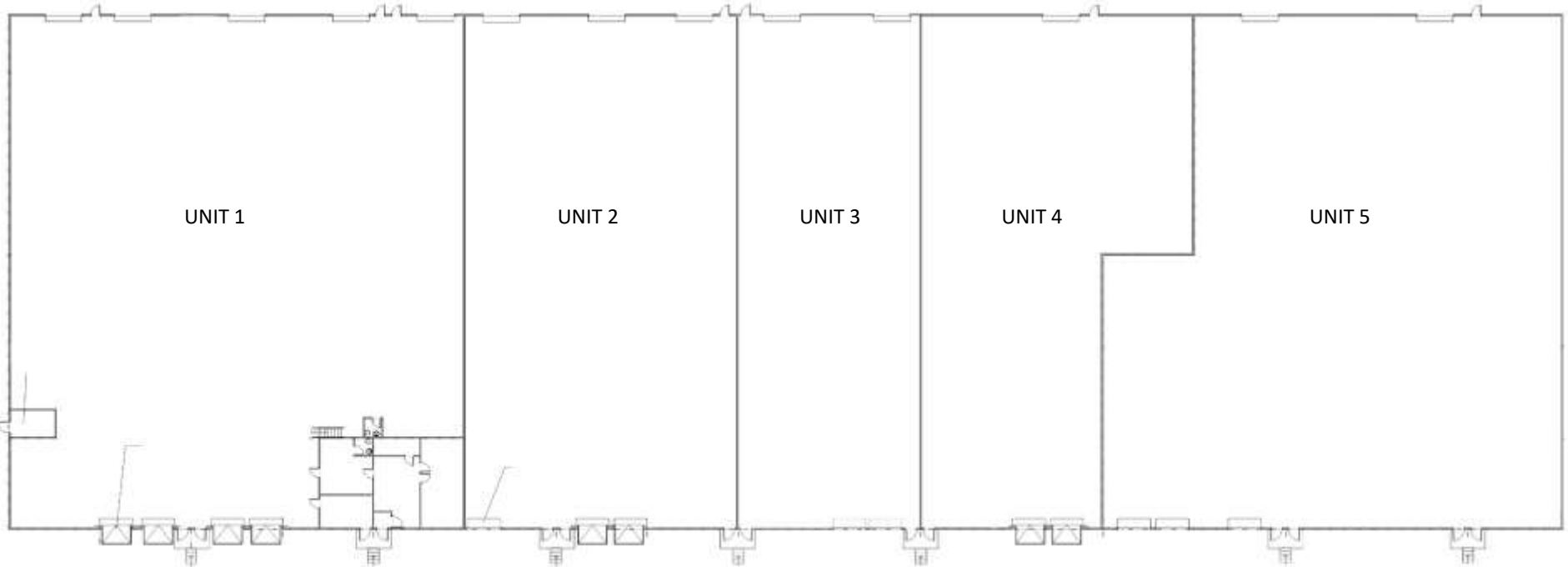

Tenants

Unit 1: Transbec (18,750 sf)

Unit 2: Atlantic Windshield (11,250 sf)

Unit 3: AK Transportation Ltd. (7,500 sf)

Unit 4: Prosol (9,375 sf)

Unit 5: Wesco (17,101 sf)

Building Features



Building Size:
63,976 sf



Dock Levellers & Ramp Loading:
Front Loading Dock, High Doors



Building Heating:
Natural Gas



Surface Rail Line:
At Rear Of Property

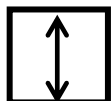

Ceiling Height:
19 Feet



Large Parking Area:
For Staff and Customers
& Large Vehicle Access



Sprinkler Systems:
Provided In All Units



Site Access:
Designed for Large
Vehicle Access

450 EDINBURGH DRIVE



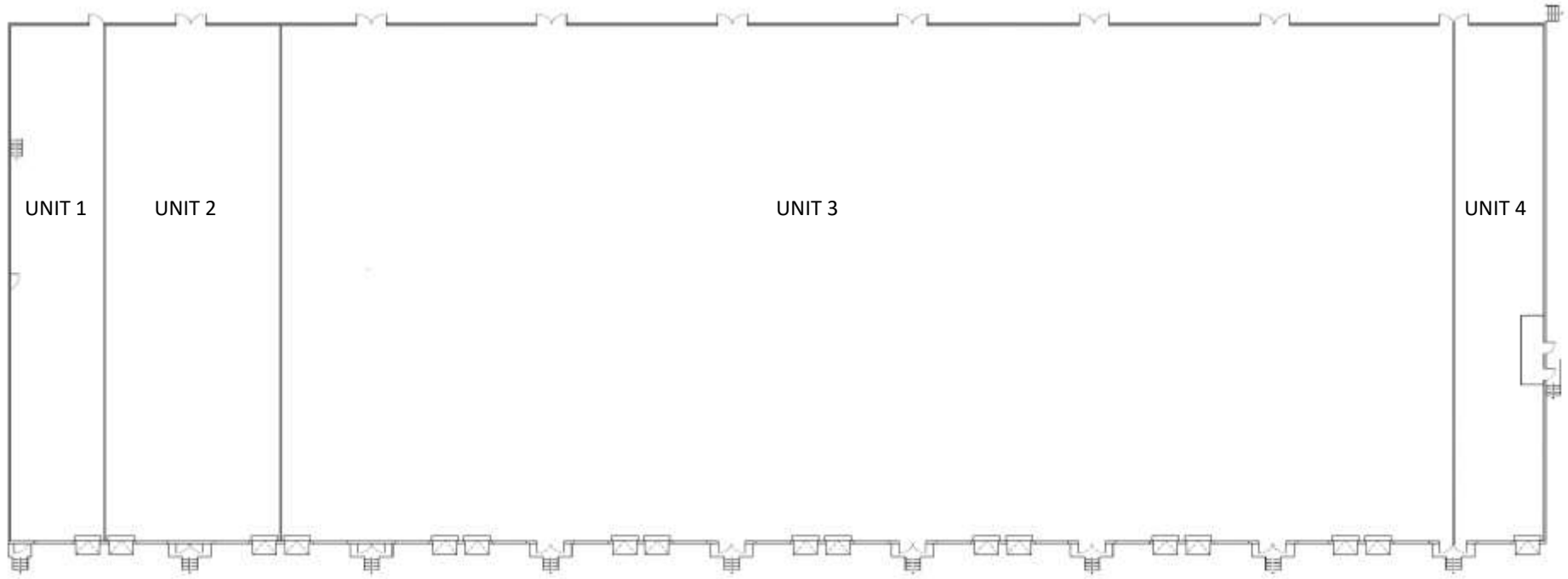





FULLY LEASED

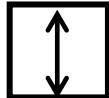

Tenants

Unit 1: GSI (3,750 sf) **Unit 2:** Robert Thibert (7,500 sf) **Unit 3:** Robert Thibert (48,750 sf) **Unit 4:** Wonder Brands (3,620 sf)

Building Features

| | | | |
|--|--|--|--|
|  Building Size: 63,976 sf |  Dock Levellers & Ramp Loading: Front Loading Dock, High Doors |  Building Heating: Natural Gas |  Surface Rail Line: At Rear Of Property |
|  Ceiling Height: 19 Feet |  Large Parking Area: For Staff and Customers & Large Vehicle Access |  Sprinkler Systems: Provided In All Units |  Site Access: Designed for Large Vehicle Access |