

450 EDINBURGH

MONCTON INDUSTRIAL PARK | MONCTON, NEW BRUNSWICK

AVAILABLE SPACE FOR LEASE

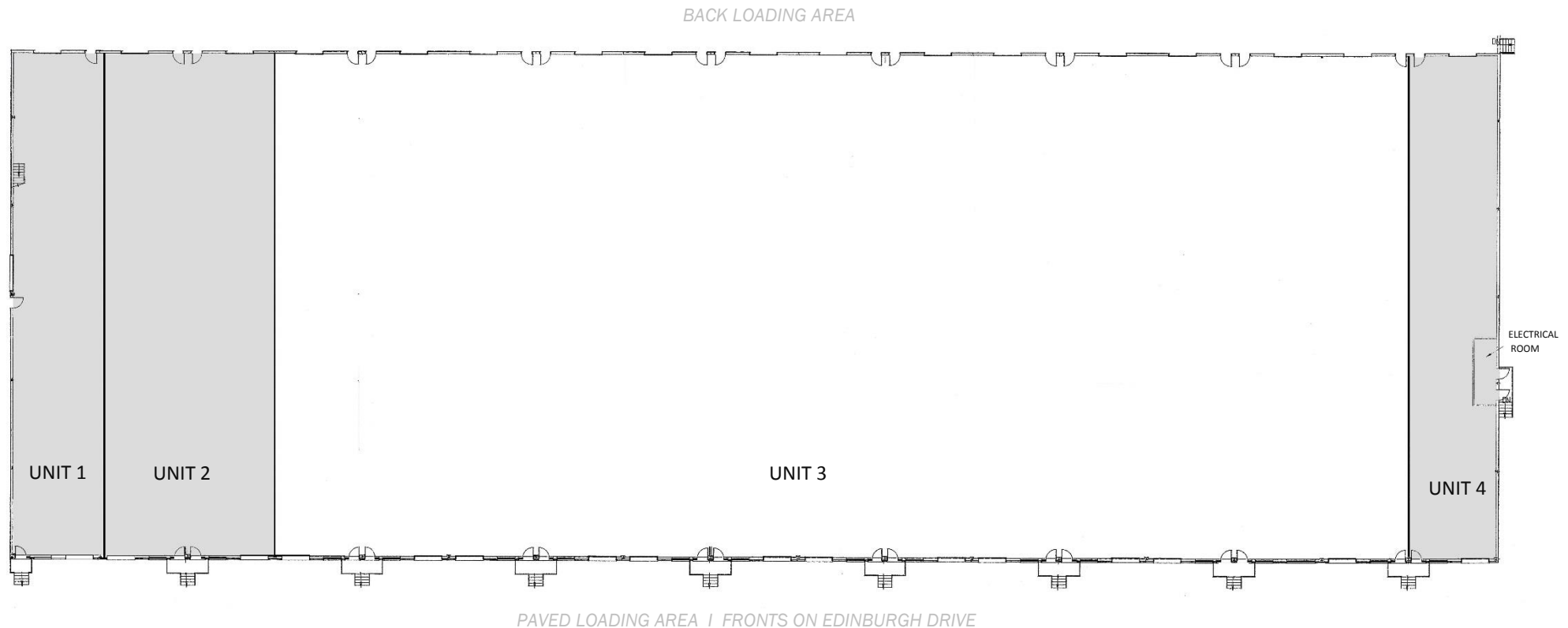

VACANCY LISTING

- Unit 1 3,700 SQ FT AVAILABLE (TEMPORARILY LEASED BY GSI)
- Unit 2 7,500 SQ FT AVAILABLE (TEMPORARILY LEASED BY ROBERT THIBERT)
- Unit 4 3,750 SQ FT AVAILABLE (TEMPORARILY LEASED BY SLEEP COUNTRY)

HGL | THE HARDMAN GROUP LIMITED
www.hardmangroup.ca

CHERYL SCHNEIDERMAN – DIRECTOR OF SALES
902-476-8752 | csmith@hardmangroup.ca

VICKI CARR – PROPERTY MANAGER
506-383-4242 | vicki.carr@hardmangroup.ca

UPDATED: FEBRUARY 15, 2018